

Message: Items belonging to a wall can only be centered along an edge that is parallel to the item's wall.

Reference Number: **KB-00822**

Last Modified: **September 17, 2024**

The information in this article applies to:



QUESTION

When I try to center an object like a door or window on a wall, I receive the following message:

- "#272032204 - Items belonging to a wall can only be centered along an edge that is parallel to the item's wall."

How do I avoid this problem?

ANSWER

This message will display when you click in a location that does not allow the program to determine which wall of a room should be used to center the object.

In order for the **Center Object** ↔ edit tool to work, two conditions must be met:

- You must click in the room that you want the object to be centered in;
- You must click sufficiently near the wall that you want to center the object along without actually clicking on the wall.

It is important that you don't click on the wall that you wish to center the selected object along.

The image below shows several instances of centering. The areas that the program can use to determine both the wall and the room that a door should be centered on are highlighted when using the **Center Object** ↔ tool.

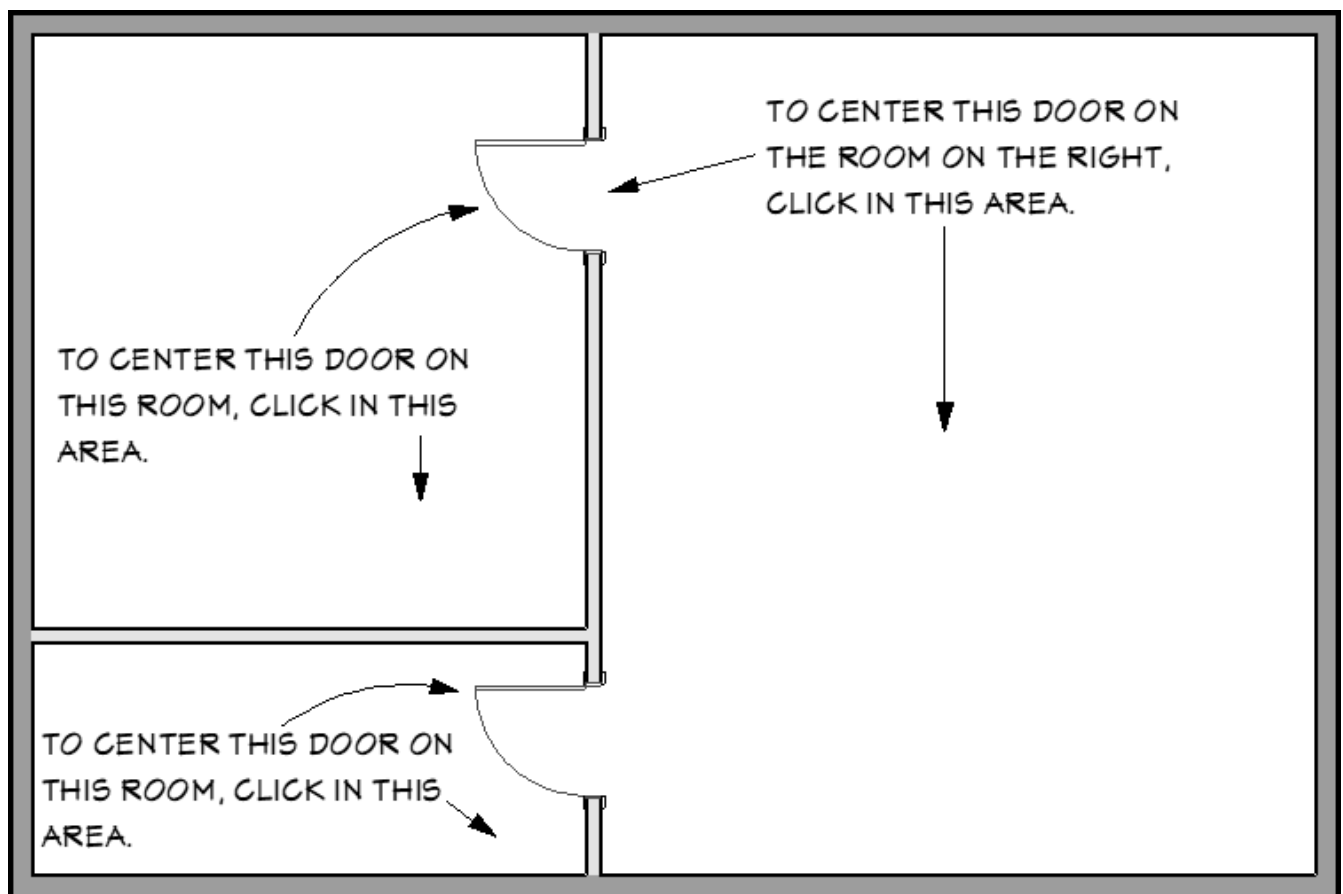

Related Articles

[Using an Insertion Point to Accurately Position a CAD Block \(/support/article/KB-01032/using-an-insertion-point-to-accurately-position-a-cad-block.html\)](/support/article/KB-01032/using-an-insertion-point-to-accurately-position-a-cad-block.html)



[\(https://chieftalk.chiefarchitect.com/\)](https://chieftalk.chiefarchitect.com/)

 [\(/blog/\)](/blog/)



<https://www.facebook.com/ChiefArchitect>



<https://www.youtube.com/user/ChiefArchitectInc>



<https://www.instagram.com/chiefarchitect/>



<https://www.houzz.com/pro/chiefarchitect/>



<https://www.pinterest.com/chiefarchitect/>

[208-292-3400 \(tel:+1-208-292-3400\)](tel:+1-208-292-3400) © 2000-2024 Chief Architect, Inc. [Terms of Use \(/company/terms.html\)](/company/terms.html)

[Privacy Policy \(/company/privacy.html\)](/company/privacy.html)