

Creating Furred Walls

Reference Number: **KB-00181**

Last Modified: **February 13, 2025**

The information in this article applies to:



QUESTION

How do I create furred walls in my basement?

ANSWER

Furred walls are useful for finishing a basement area and to provide room for insulation. This can easily be represented using the furred wall setting.

Alternatively, you may find it more effective to define a wall type with multiple framing layers. For more information on this process, please see the "Defining a New Wall Type" resource in the [Related Articles](#) section below.

To create furred walls

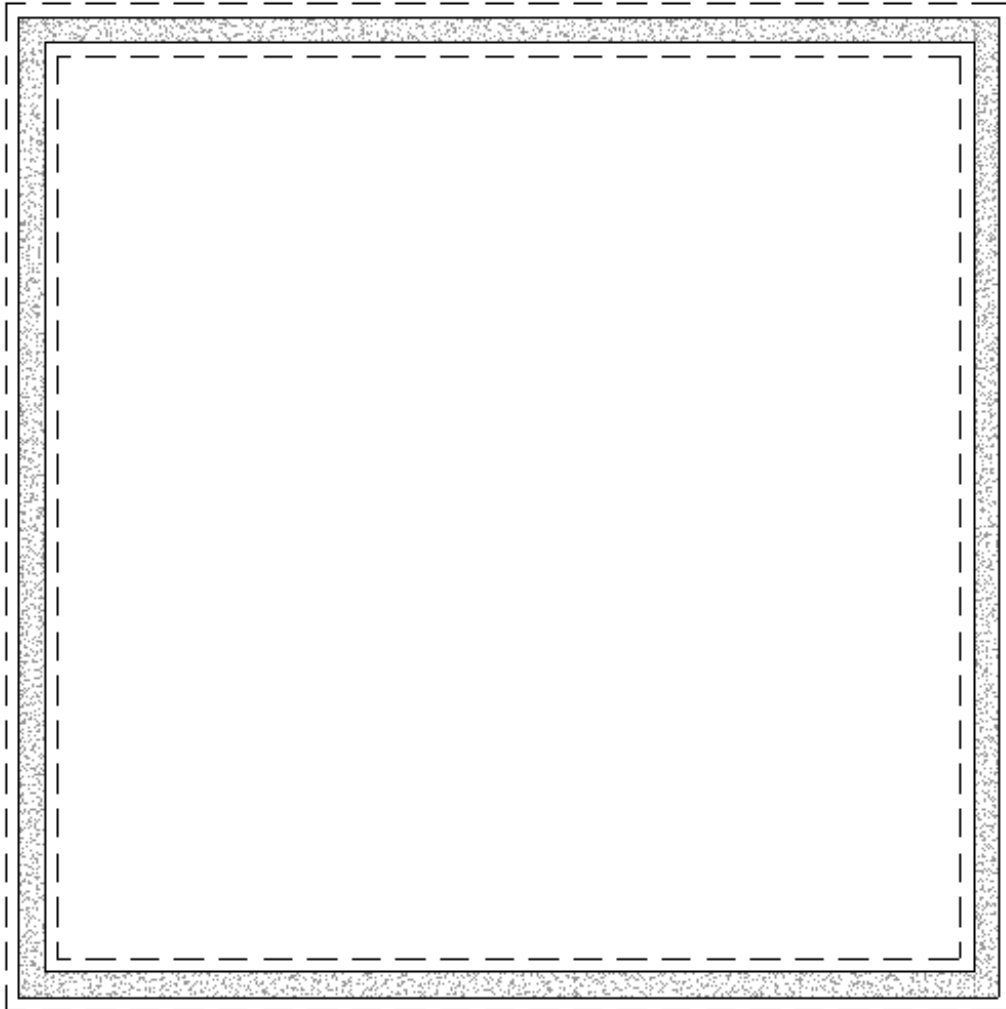

1. If a foundation has not already been created, select **Build> Floor> Build Foundation**  from the menu, specify your desired settings within the **Build Foundation** dialog, then click **OK**.

2. Choose the option to **Derive new foundation plan from the 1st floor plan** and click **OK** to generate the foundation.



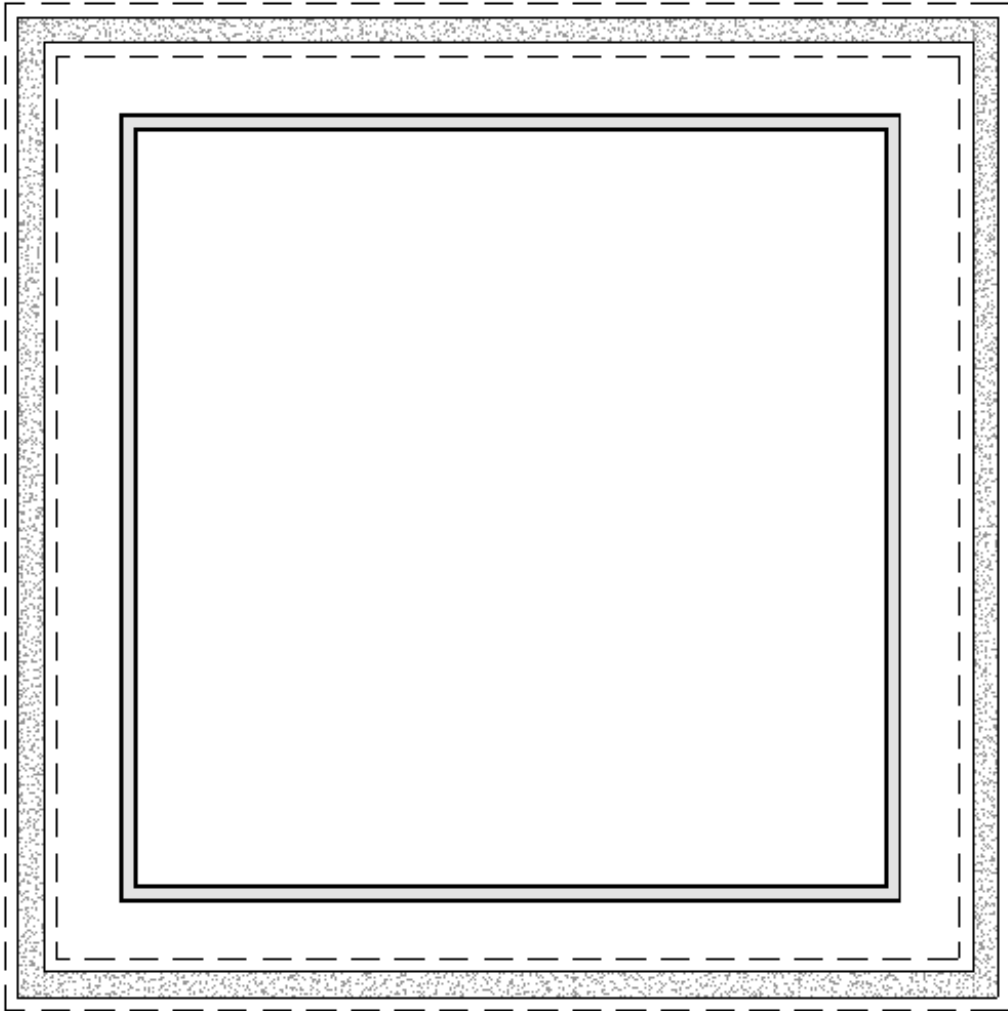

3. Navigate to **Build> Wall> Straight Interior Wall** , then draw interior walls parallel to the foundation walls.



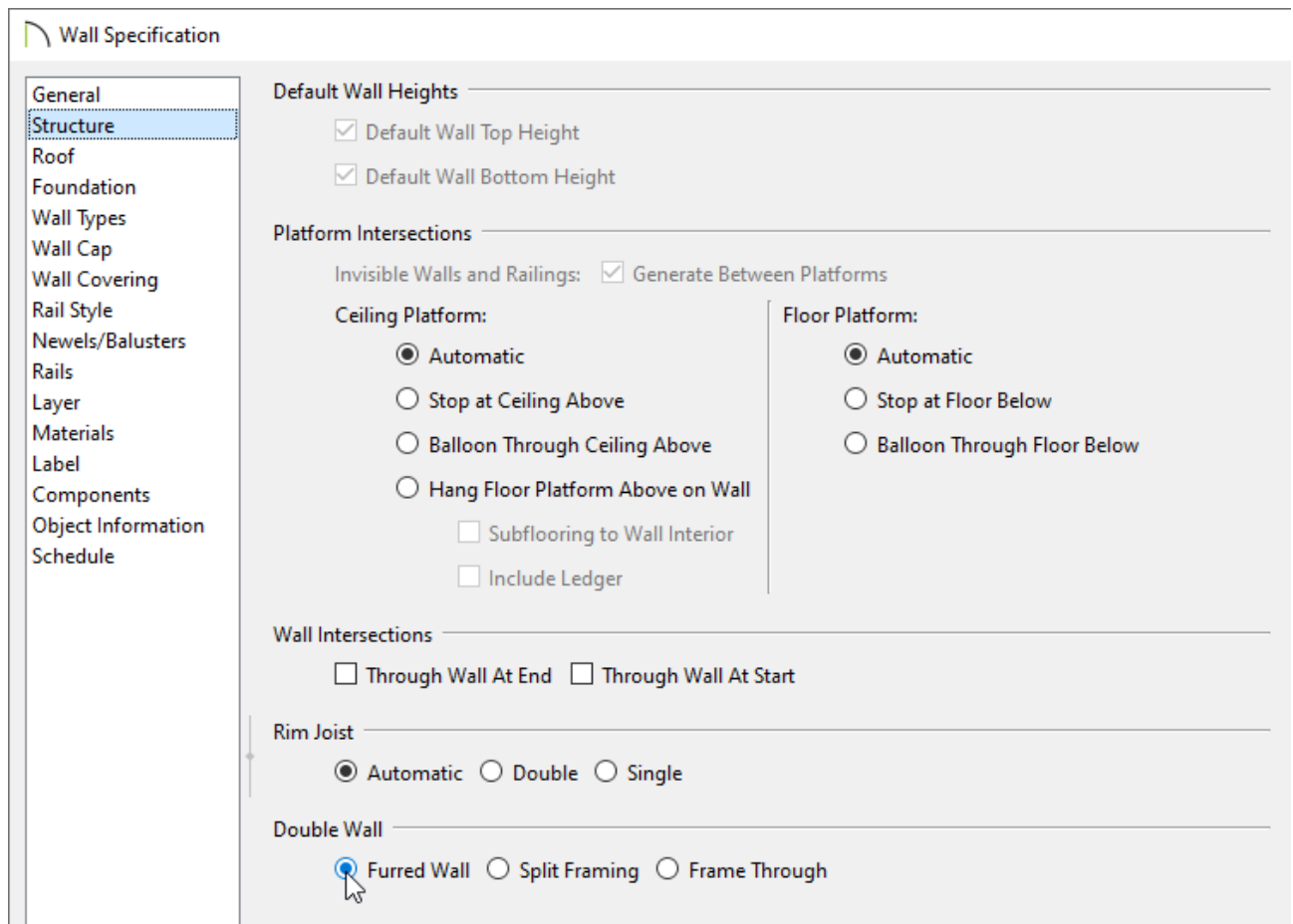

4. Using the **Select Objects**  tool, hold down the **Shift** key on your keyboard, click on each of the interior walls to group select them, then click the **Open Object**  edit tool.
5. On the **STRUCTURE** panel of the **Wall Specification** dialog that opens, select the **Furred Wall** option under the Double Wall section, then click **OK**.

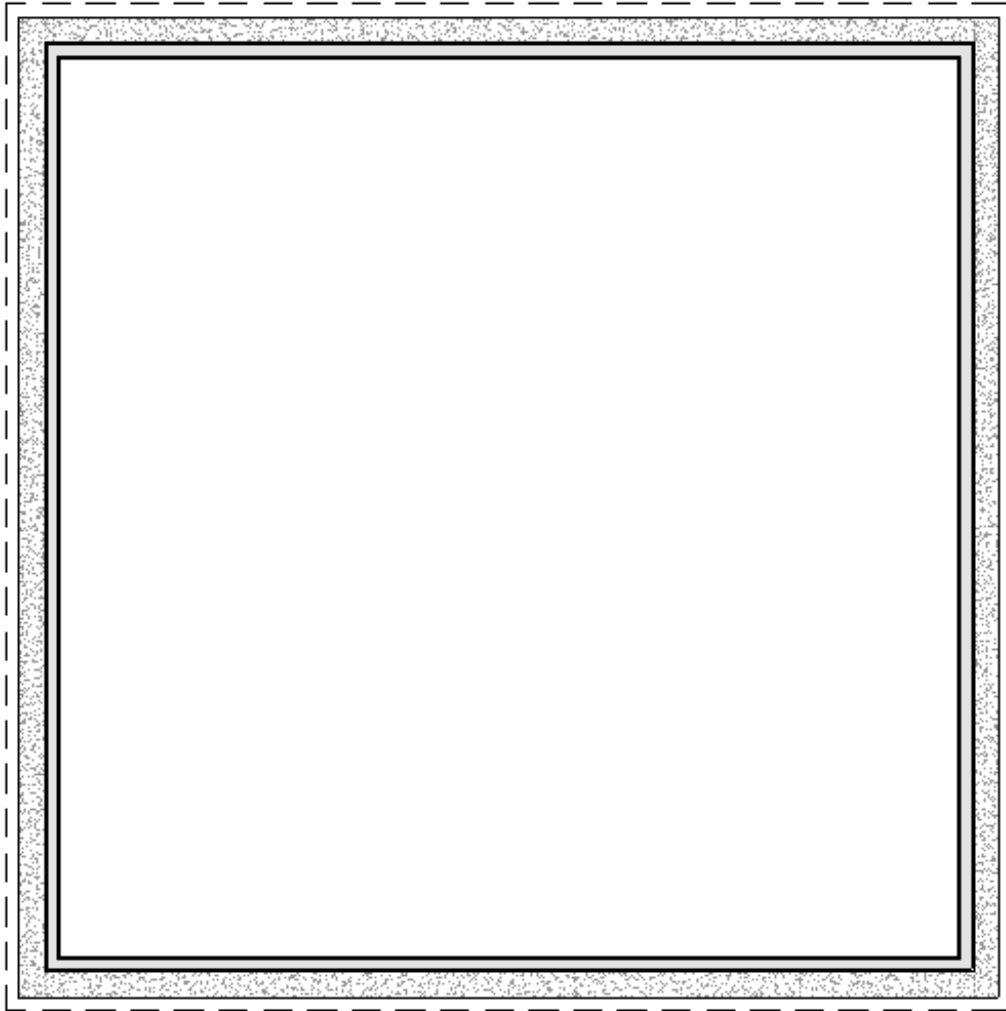

- Using the **Select Object**  tool, select each interior wall and **Move**  them so they bump up against the foundation walls.



7. Now, if an opening, such as a **Door**  or **Window** , is placed into a wall on the foundation level, we can see that it now cuts through both walls.

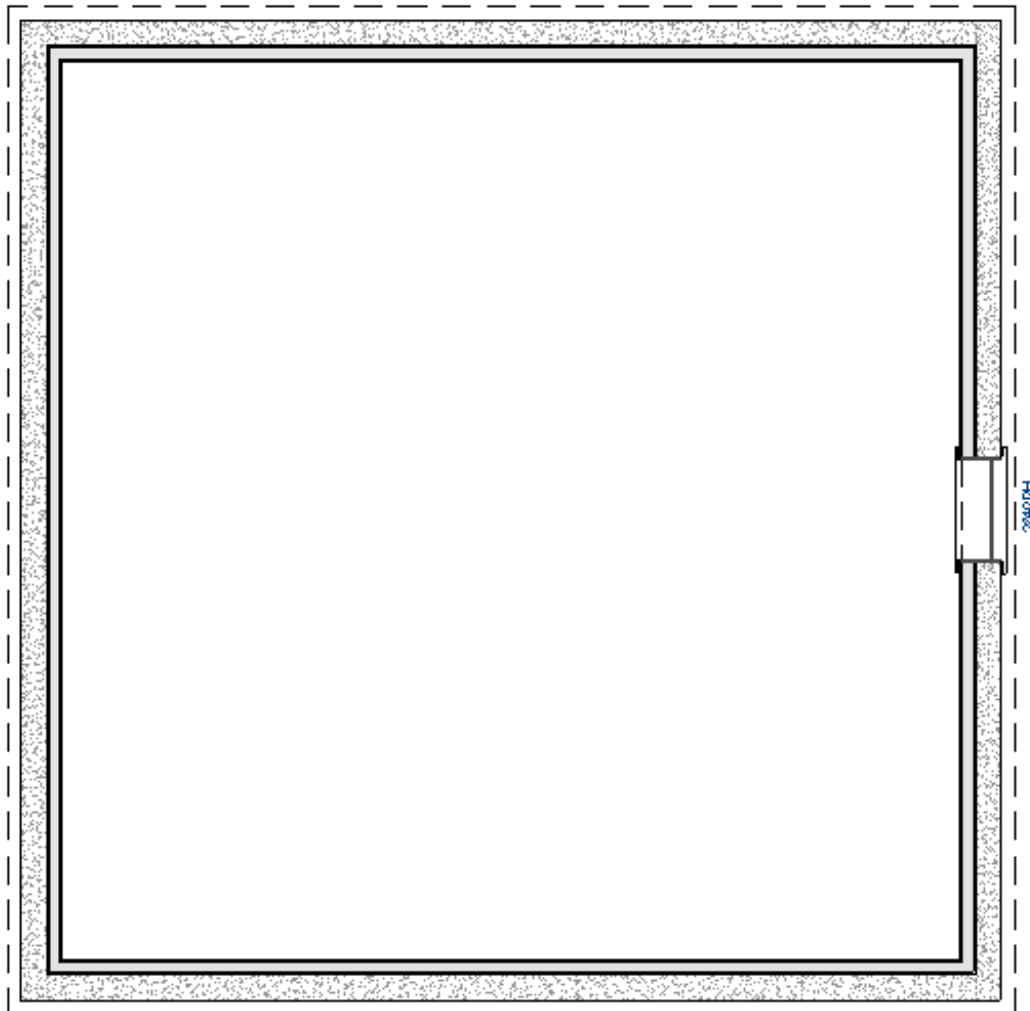

Related Articles

[📄 Changing an Existing Wall's Type \(/support/article/KB-00443/changing-an-existing-wall-s-type.html\)](/support/article/KB-00443/changing-an-existing-wall-s-type.html)

[📄 Defining a New Wall Type \(/support/article/KB-02944/defining-a-new-wall-type.html\)](/support/article/KB-02944/defining-a-new-wall-type.html)

[📄 Group Selecting Objects \(/support/article/KB-00623/group-selecting-objects.html\)](/support/article/KB-00623/group-selecting-objects.html)



[\(https://chieftalk.chiefarchitect.com/\)](https://chieftalk.chiefarchitect.com/)

 (/blog/)



[\(https://www.facebook.com/ChiefArchitect\)](https://www.facebook.com/ChiefArchitect)



[\(https://www.youtube.com/user/ChiefArchitectInc\)](https://www.youtube.com/user/ChiefArchitectInc)



[\(https://www.instagram.com/chiefarchitect/\)](https://www.instagram.com/chiefarchitect/)



[\(https://www.houzz.com/pro/chiefarchitect/\)](https://www.houzz.com/pro/chiefarchitect/)



[\(https://www.pinterest.com/chiefarchitect/\)](https://www.pinterest.com/chiefarchitect/)

[208-292-3400 \(tel:+1-208-292-3400\)](tel:+1-208-292-3400)

© 2000–2025 Chief Architect, Inc.

[Terms of Use \(/company/terms.html\)](/company/terms.html)

[Privacy Policy \(/company/privacy.html\)](/company/privacy.html)