

Using a Bluetooth Laser Measuring Device with Chief Architect As-Built

Reference Number: **KB-02905**

Last Modified: **June 25, 2026**

QUESTION

Can I use a bluetooth laser measuring device with the Chief Architect As-Built application?

ANSWER

If you're using a supported Apple device (<https://www.chiefarchitect.com/support/article/KB-03250/apple-devices-compatible-with-chief-architect-as-built.html>), you can use a bluetooth laser measuring device in unison with the As-Built application to capture measurements of an existing space.

Though not exhaustive, the following bluetooth laser measuring devices have been tested by Chief Architect and are listed as compatible with As-Built:

- Leica D2, E7100i (D110), E7500i (D510), D810, and S910
- Bosch GLM 50C and 100C

Connecting and using a bluetooth laser measuring device with As-Built

1. Turn on bluetooth on the Apple device.

Do not pair your Apple device with the bluetooth laser measuring device at this time.

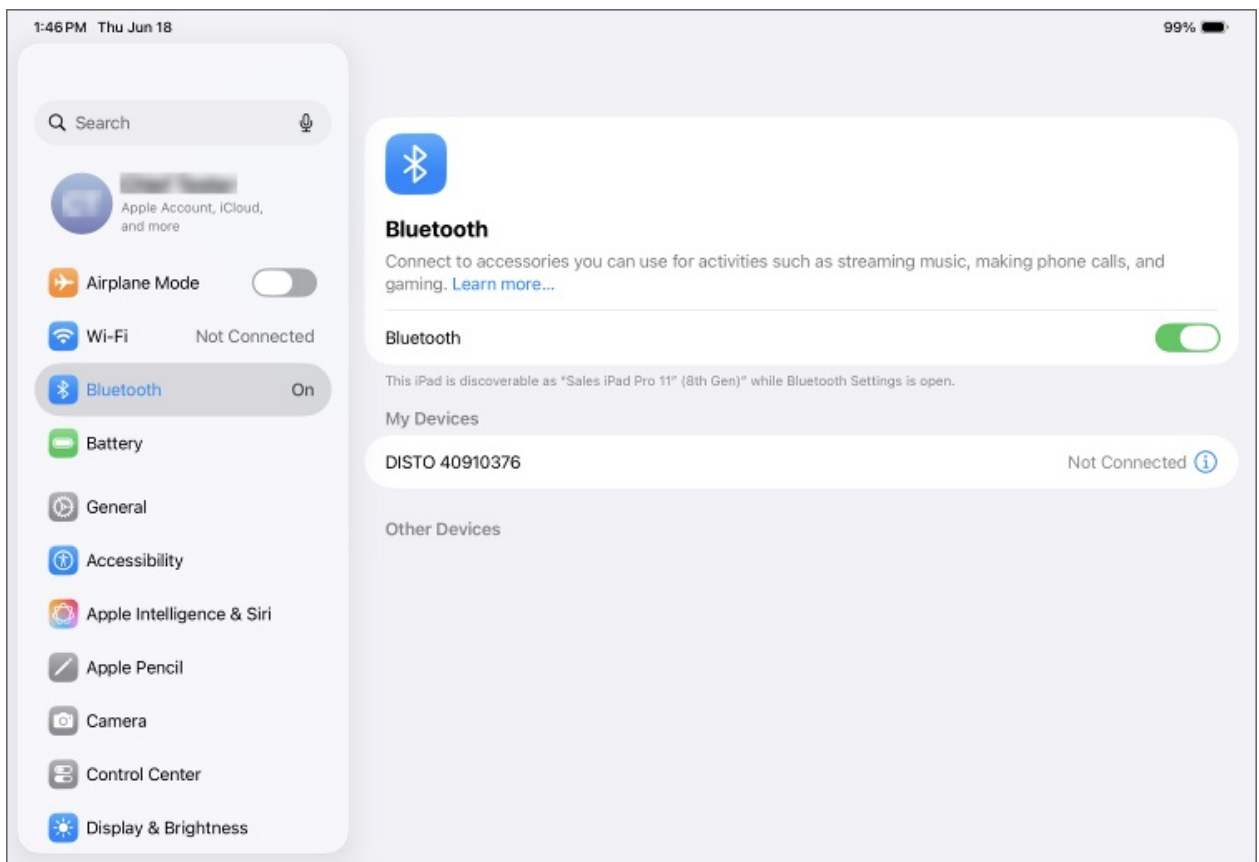

2. Access the As-Built application, then tap the **Settings**  icon at

the bottom.

3. Select **Bluetooth Measuring Devices** at the bottom of the Settings menu to open the **Bluetooth Devices** dialog.

Your bluetooth laser measuring device should be listed with the words "Not Connected".

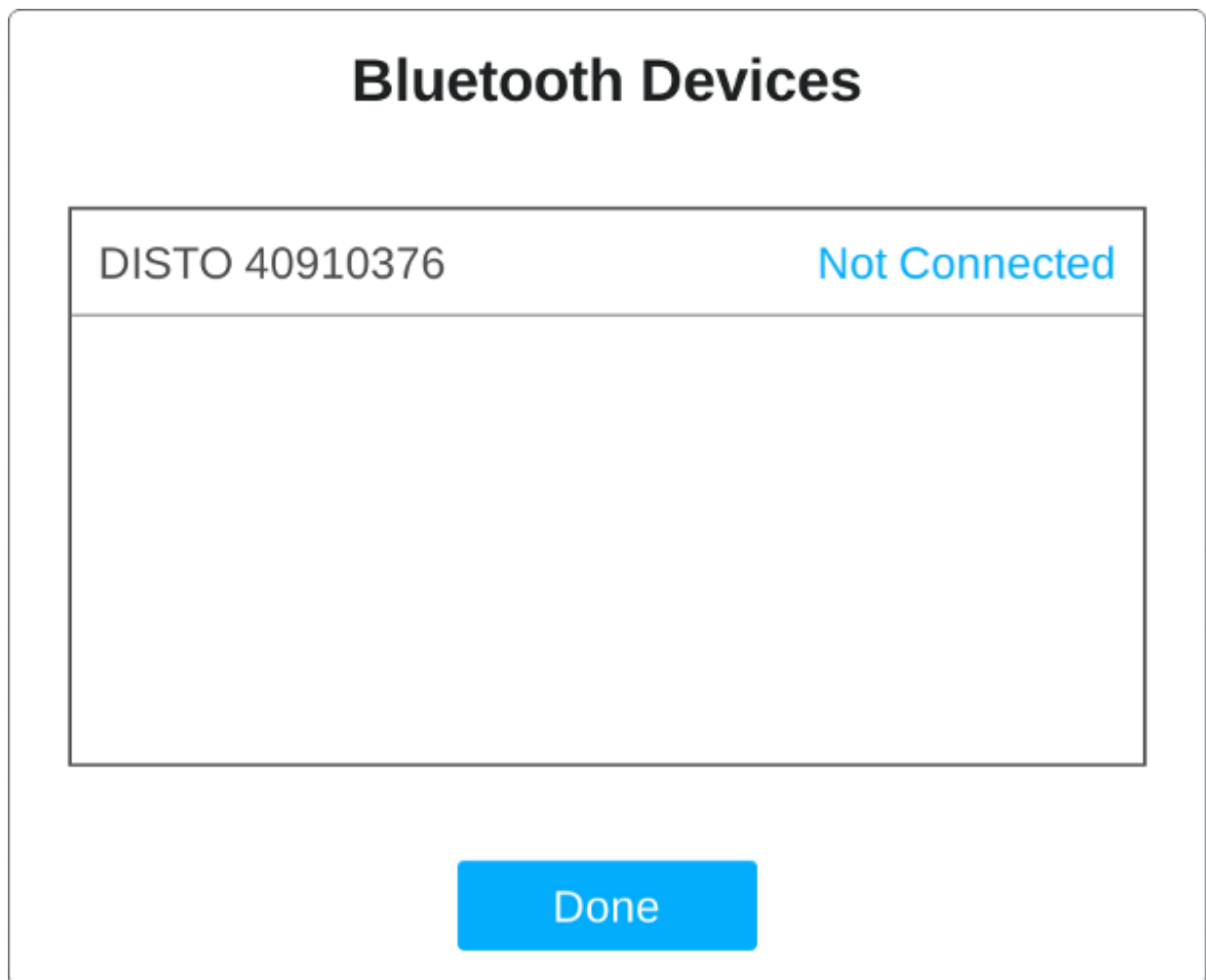

4. Tap on the name of the bluetooth device to start the pairing process. If prompted, click the **Pair** button.

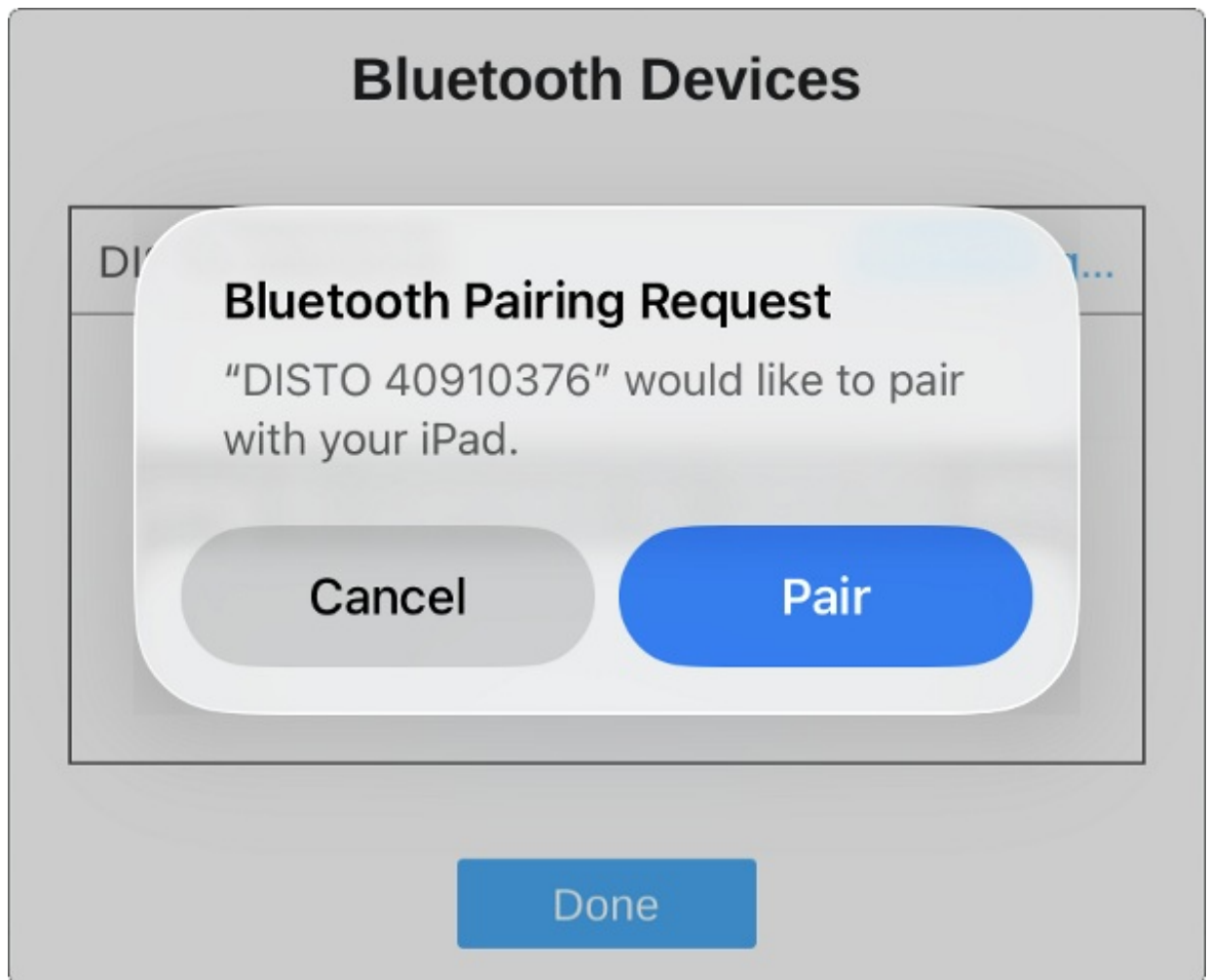

Once paired, the word "Connected" should display next to the device, as shown in the image below.

Note: If the device fails to connect, tap on the device name once again. If you're still unable to connect your bluetooth laser measuring device to As-Built, restart your Apple device, disable and re-enable the bluetooth functionality within your device settings, then repeat Steps 2 - 4.

Bluetooth Devices

DISTO 40910376

Connected

Done

5. Tap **Done** button to close the dialog, then access the plan that you want to use the bluetooth laser measuring device with.
6. Tap on the wall that you'd like to move, then tap the blue dimension box that is adjacent to the selected wall to bring up the keyboard and/or an input line.

Note: Some bluetooth laser measuring devices will not prompt the keyboard to appear. Instead, only an input line will appear. Continue with the steps below.

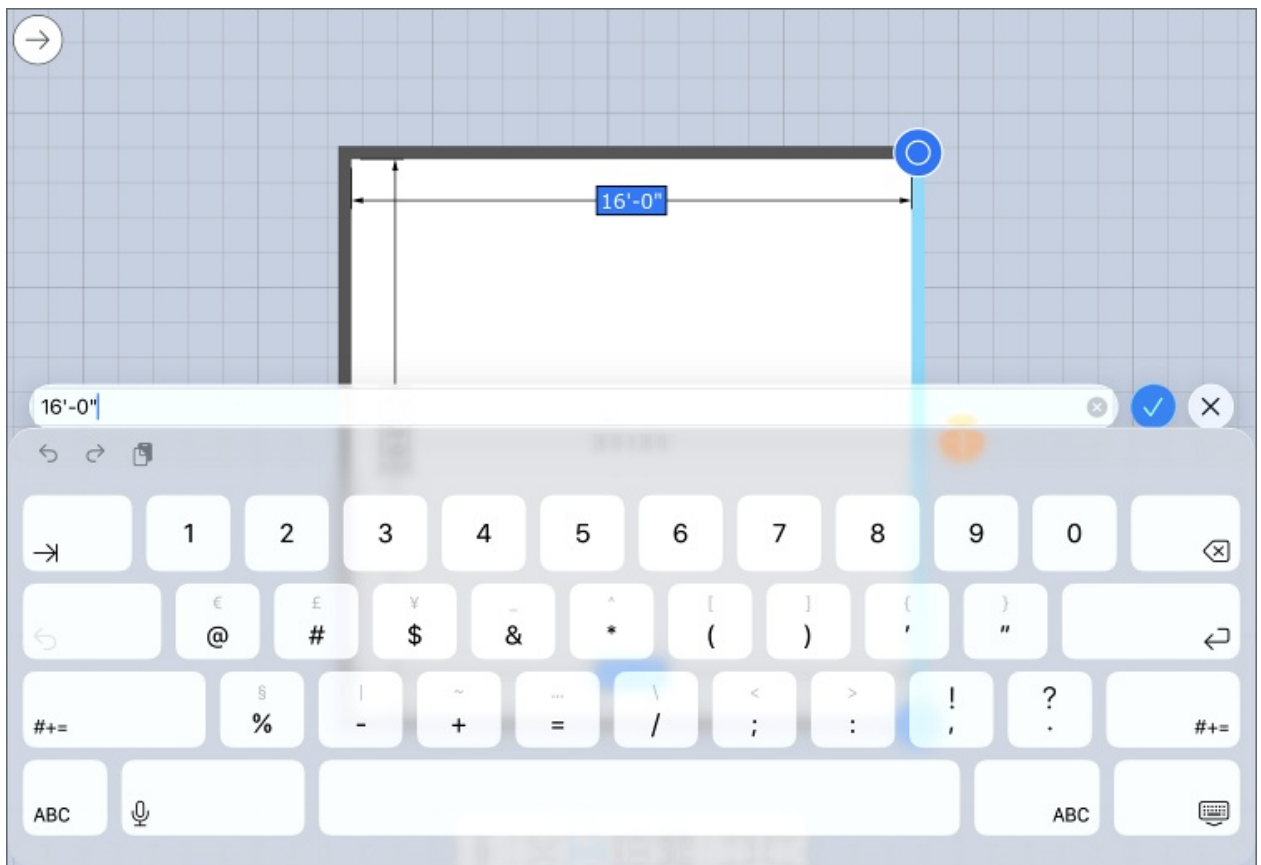

7. Capture a measurement using the bluetooth laser measuring device, and notice that the captured measurement will override the value that was originally set.

As you can see in the image below, the measurement captured with the bluetooth laser measuring device was 10' 4\"/>

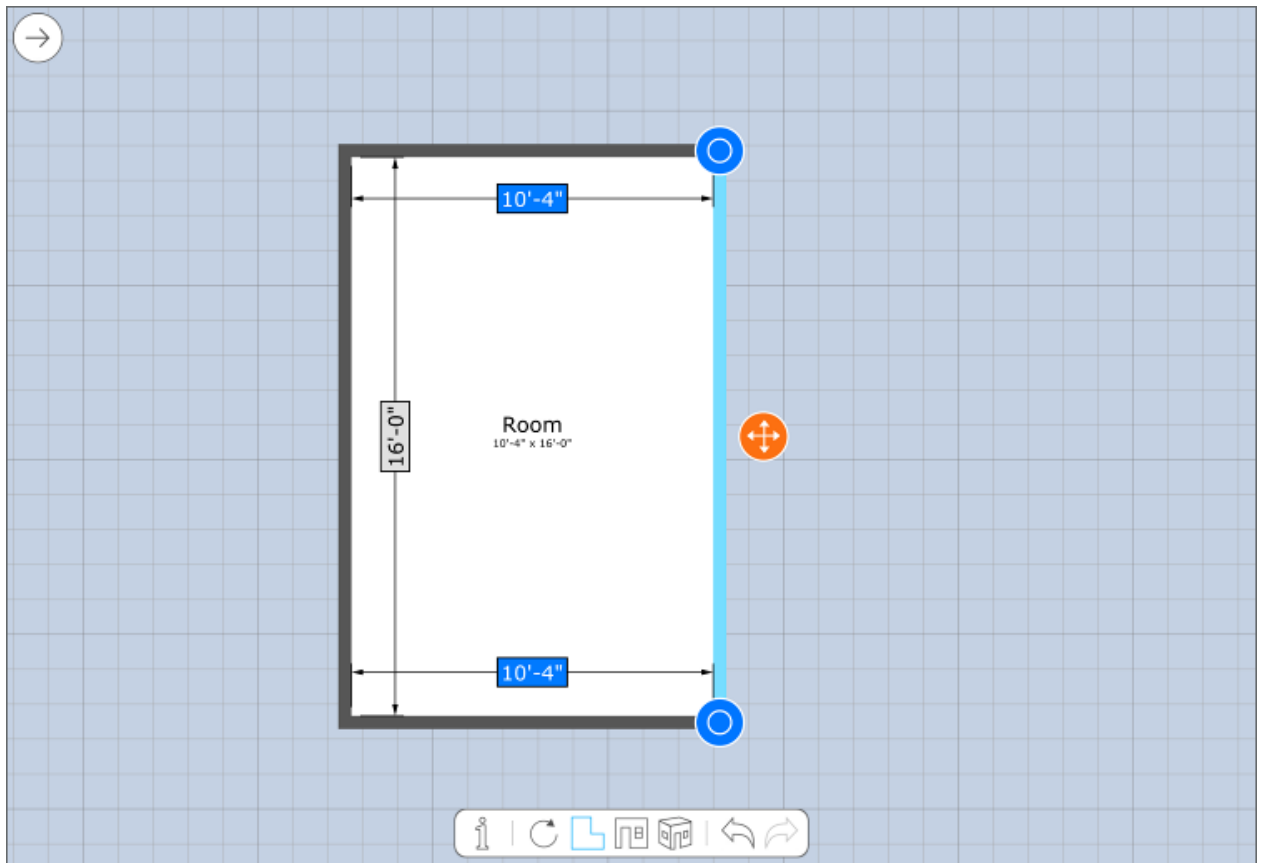

8. Continue this procedure for each wall or opening that you would like to update or measure using the bluetooth laser measuring device.

Related Articles

- [📄 Apple Devices Compatible with Chief Architect As-Built \(/support/article/KB-03250/apple-devices-compatible-with-chief-architect-as-built.html\)](/support/article/KB-03250/apple-devices-compatible-with-chief-architect-as-built.html)
- [📄 Using a Leica DISTO™ Device with Chief Architect Software \(/support/article/KB-01846/using-a-leica-disto-device-with-chief-architect-software.html\)](/support/article/KB-01846/using-a-leica-disto-device-with-chief-architect-software.html)



[\(https://chieftalk.chiefarchitect.com/\)](https://chieftalk.chiefarchitect.com/)

 [\(/blog/\)](/blog/)



[\(https://www.facebook.com/ChiefArchitect\)](https://www.facebook.com/ChiefArchitect)



[\(https://www.youtube.com/user/ChiefArchitectInc\)](https://www.youtube.com/user/ChiefArchitectInc)



[\(https://www.instagram.com/chiefarchitect/\)](https://www.instagram.com/chiefarchitect/)



[\(https://www.houzz.com/pro/chiefarchitect/\)](https://www.houzz.com/pro/chiefarchitect/)



[\(https://www.pinterest.com/chiefarchitect/\)](https://www.pinterest.com/chiefarchitect/)

[208-292-3400 \(tel:+1-208-292-3400\)](tel:+1-208-292-3400)

© 2000–2026 Chief Architect, Inc.

[Terms of Use \(/company/terms.html\)](/company/terms.html)

[Privacy Policy \(/company/privacy.html\)](/company/privacy.html)