

Using a Bluetooth Measuring Device with Chief Architect As-Built

Reference Number: **KB-02905**

Last Modified: **June 23, 2026**

QUESTION

Can I use a bluetooth measuring device with the Chief Architect As-Built application?

ANSWER

If you're using a supported Apple device, you can use a bluetooth measuring device in unison with the As-Built application to capture measurements of an existing space.

Supported bluetooth measuring devices include, but are not limited to:

- Leica (e.g. D2, E7100i (D110), E7500i (D510), D810, S910, etc.) devices
- Bosch (e.g. GLM 50c, 100c, etc.) devices

Connecting and using a bluetooth measuring device with As-Built

1. Turn on bluetooth on the Apple device.

Do not pair your Apple device with the bluetooth measuring device in the device settings.

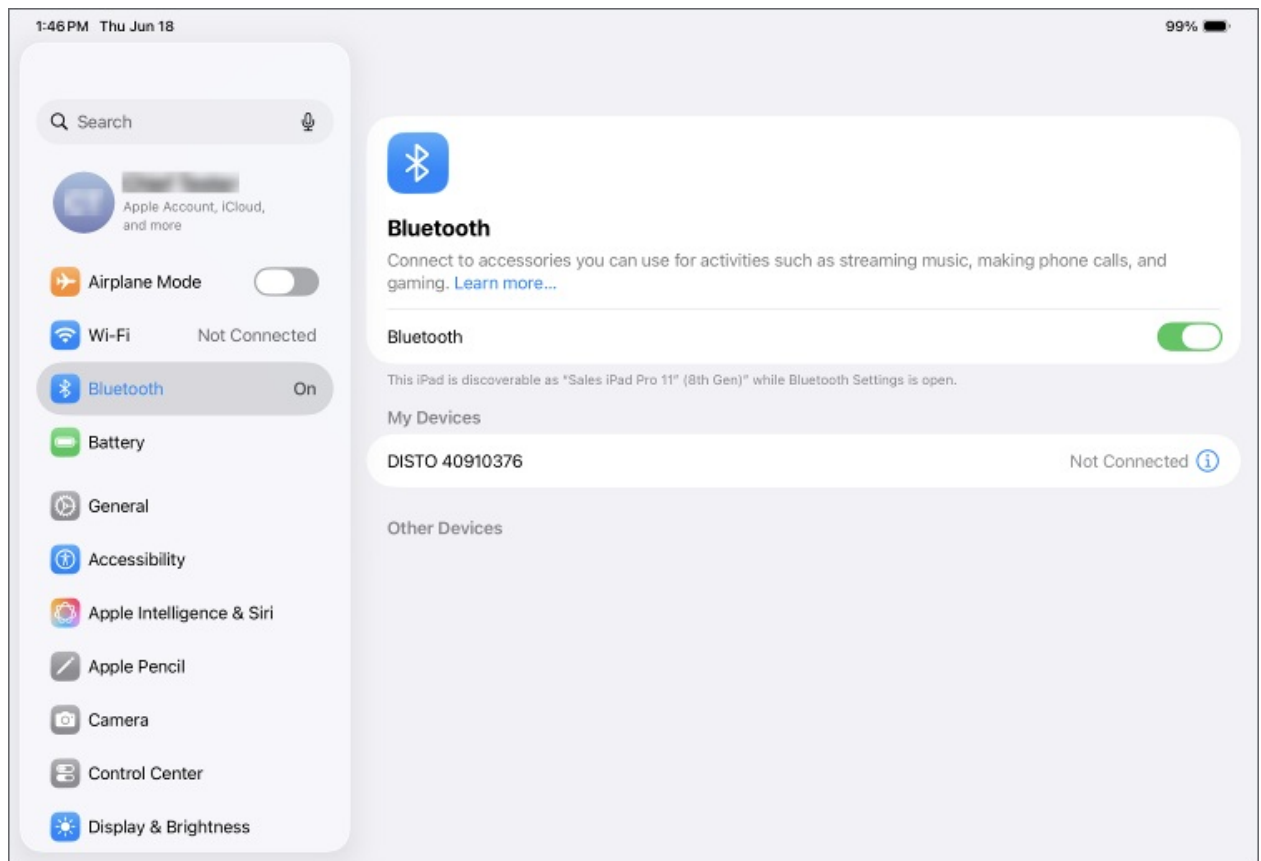

2. Access the As-Built application, then tap the **Settings**  icon at the bottom.

3. Select **Bluetooth Measuring Devices** at the bottom of the Settings menu to open the **Bluetooth Devices** dialog.

You should see your bluetooth measuring device in this list with the words "Not Connected".

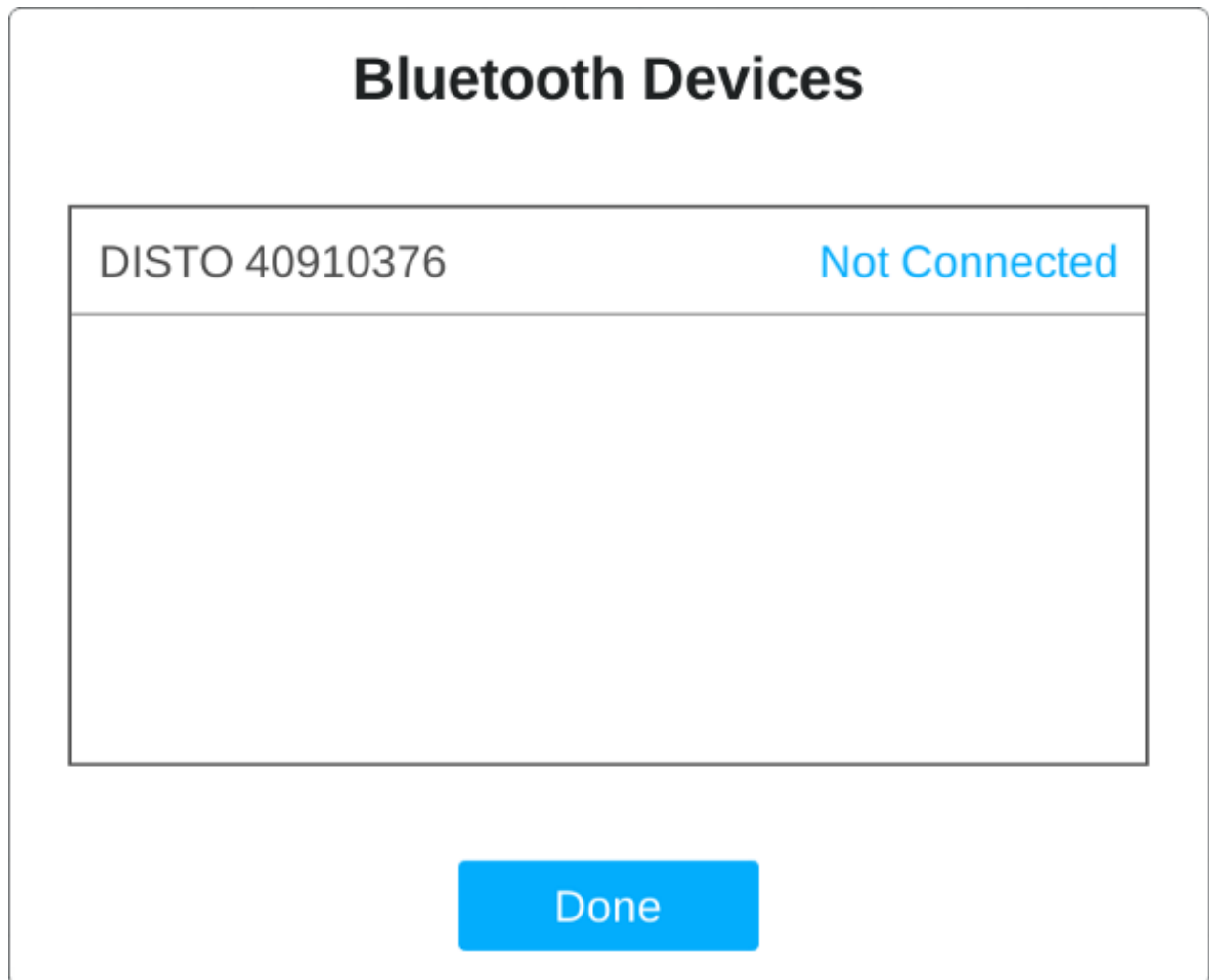

4. Tap on the name of the bluetooth device to start the pairing process. If prompted, click the **Pair** button.

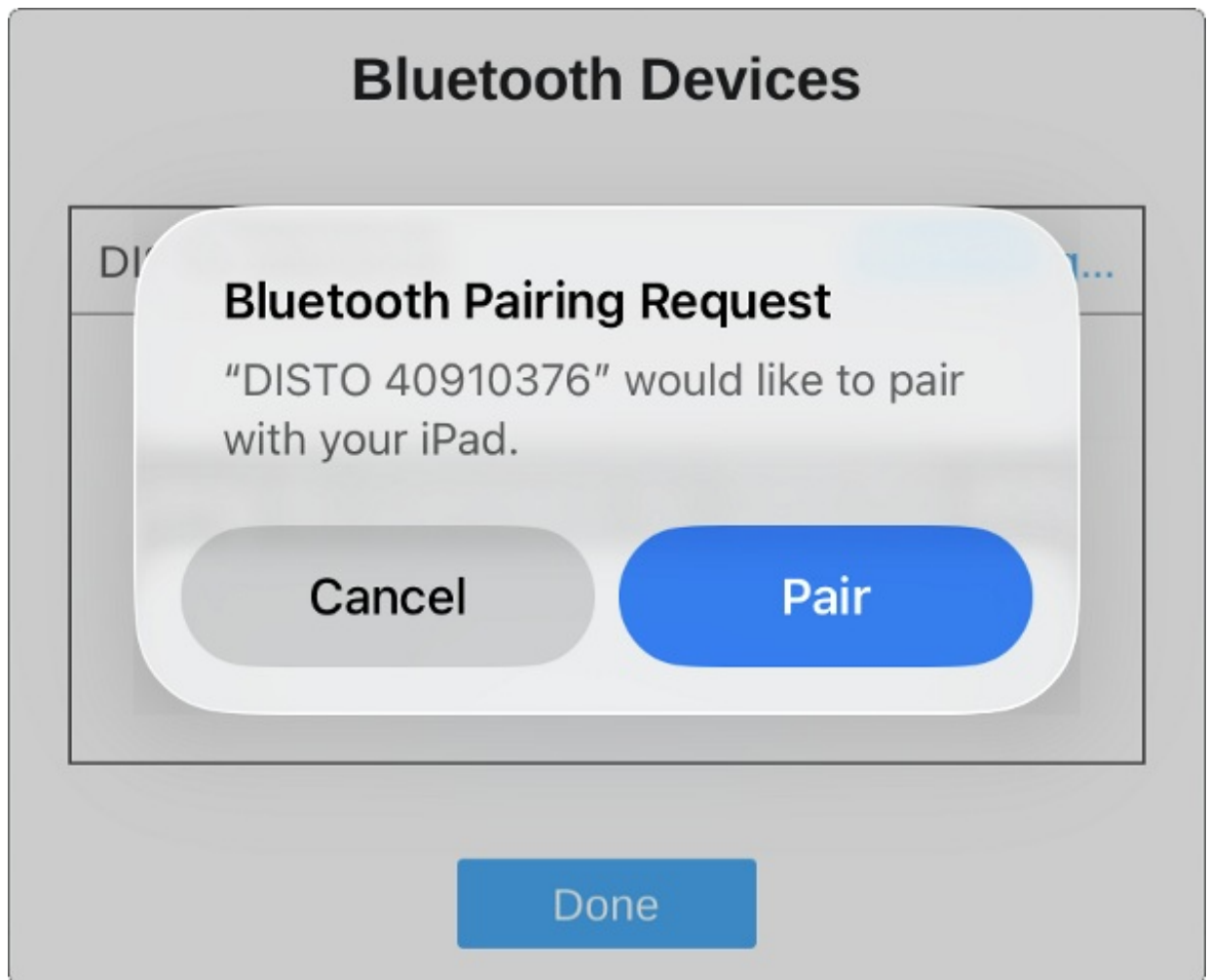

Once paired and connected, the word "Connected" should display in the Bluetooth Devices dialog, as shown below.

Note: If the device fails to connect, tap on the device name once again. If you're still unable to connect your bluetooth measuring device to As-Built, restart your Apple device, disable and re-enable the bluetooth functionality within your device settings, then repeat Steps 2 - 4.

Bluetooth Devices

DISTO 40910376

Connected

Done

5. Tap the **Done** button to close the dialog, then access the plan that you want to use the bluetooth measuring device with.
6. Tap on the wall that you'd like to move, then tap the blue dimension box that is adjacent to the selected wall to bring up the keyboard along with an input line.

Note: Some bluetooth measuring devices will not prompt the keyboard to appear. Instead, only the input line will appear; continue with the steps below.

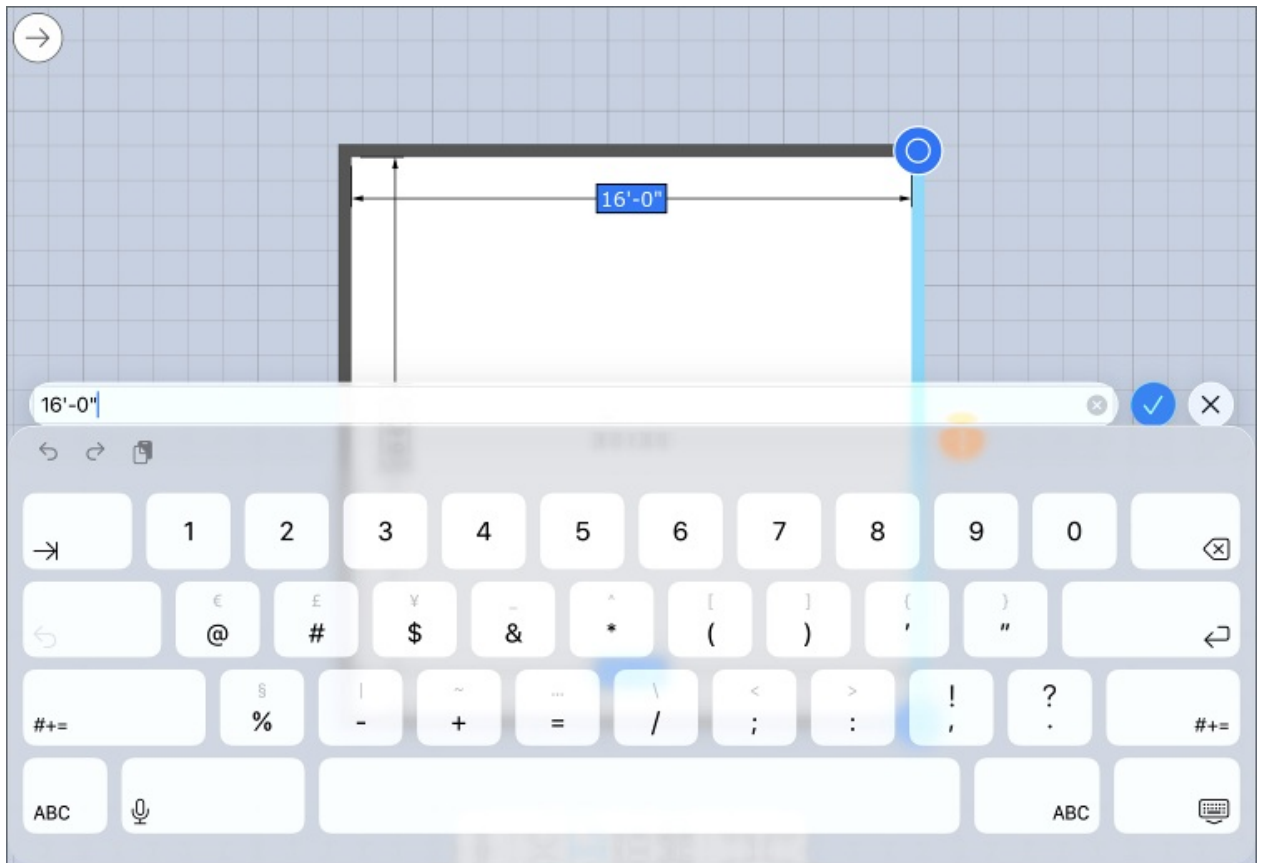

7. Capture a measurement using the bluetooth measuring device, and notice that the captured measurement will override the value that was originally set.

As you can see in the image below, the measurement captured with the bluetooth measuring device was 10' 4".

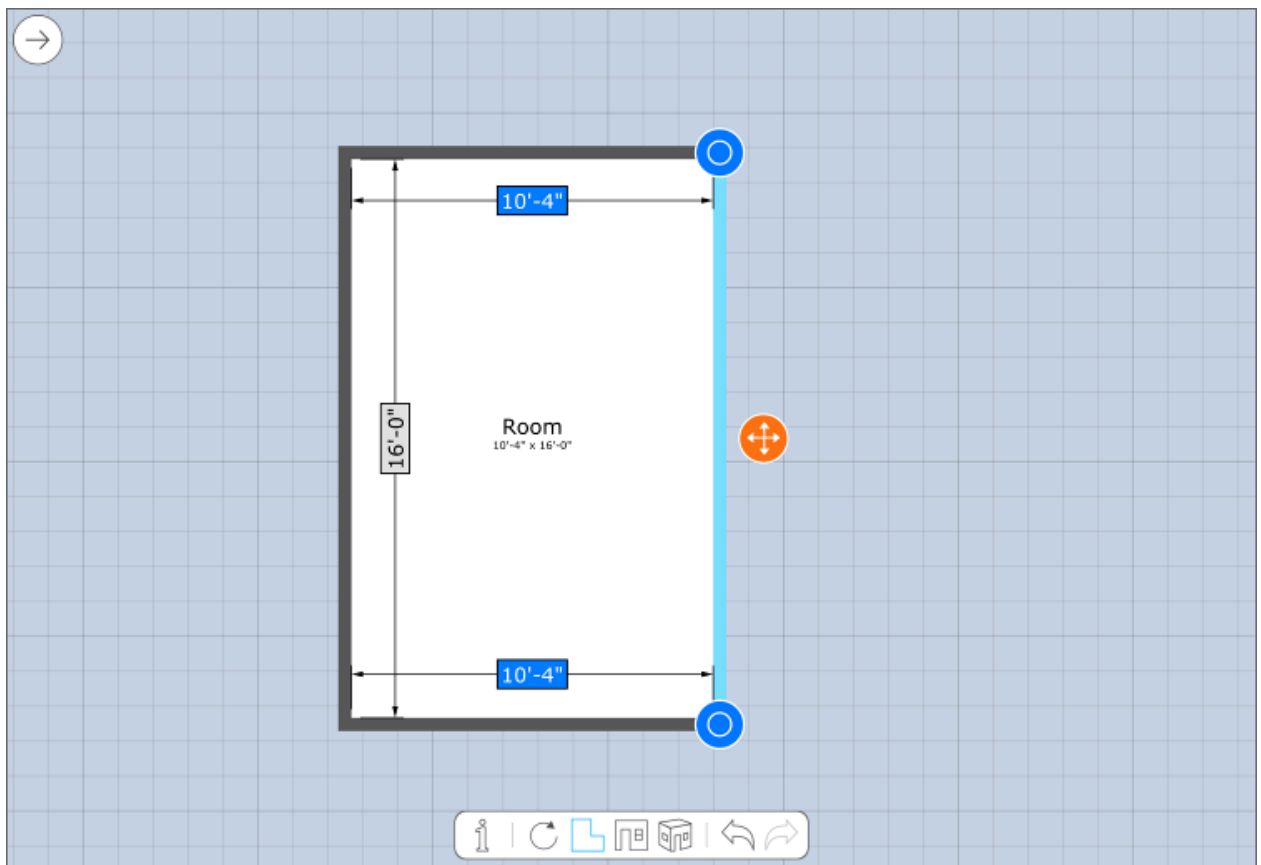

8. Continue this procedure for each wall or opening that you would like to update or measure using the bluetooth measuring device.

Related Articles

- [📄 Apple Devices Compatible with Chief Architect As-Built \(/support/article/KB-03250/apple-devices-compatible-with-chief-architect-as-built.html\)](/support/article/KB-03250/apple-devices-compatible-with-chief-architect-as-built.html)
- [📄 Using a Leica DISTO™ Device with Chief Architect Software \(/support/article/KB-01846/using-a-leica-disto-device-with-chief-architect-software.html\)](/support/article/KB-01846/using-a-leica-disto-device-with-chief-architect-software.html)



[\(https://chieftalk.chiefarchitect.com/\)](https://chieftalk.chiefarchitect.com/)

 [\(/blog/\)](/blog/)



[\(<https://www.facebook.com/ChiefArchitect>\)](https://www.facebook.com/ChiefArchitect)



[\(<https://www.youtube.com/user/ChiefArchitectInc>\)](https://www.youtube.com/user/ChiefArchitectInc)



[\(<https://www.instagram.com/chiefarchitect/>\)](https://www.instagram.com/chiefarchitect/)



[\(<https://www.houzz.com/pro/chiefarchitect/>\)](https://www.houzz.com/pro/chiefarchitect/)



[\(<https://www.pinterest.com/chiefarchitect/>\)](https://www.pinterest.com/chiefarchitect/)

[208-292-3400 \(tel:+1-208-292-3400\)](tel:+1-208-292-3400)

© 2000–2026 Chief Architect, Inc.

[Terms of Use \(/company/terms.html\)](/company/terms.html)

[Privacy Policy \(/company/privacy.html\)](/company/privacy.html)